



Cuvette Holder

Technical specifications

Ref: CUV-ISI-TEC 001-01

Date: 2017-05-12

www.is-instruments.com

Contact Details

Correspondence
Address:

IS-Instruments Ltd.
Pipers Business Centre
220 Vale Road
Tonbridge
Kent
TN9 1SP
UK

Email:

info@is-instruments.com

Phone:

+44 (0)1732 373020 (09:00 – 17:00 UK)

Fax:

+44 (0)1732 373001



Disclaimer

THE INFORMATION CONTAINED HEREIN IS PROVIDED "AS IS" WITHOUT WARRANTY, CONDITION OR REPRESENTATION OF ANY KIND, EITHER EXPRESS, IMPLIED, STATUTORY OR OTHERWISE, INCLUDING BUT NOT LIMITED TO, ANY WARRANTY OF MERCHANTABILITY, NON-INFRINGEMENT OR FITNESS FOR A PARTICULAR PURPOSE.

IN NO EVENT SHALL IS-INSTRUMENTS BE LIABLE FOR ANY LOSS OR DAMAGE, WHETHER DIRECT, INDIRECT, SPECIAL, INCIDENTAL, CONSEQUENTIAL OR OTHERWISE HOWSOEVER CAUSED WHETHER ARISING IN CONTRACT TORT OR OTHERWISE, ARISING OUT OF OR IN CONNECTION WITH THE USE OF THE INFORMATION PROVIDED HEREIN.

COPYRIGHT AND PROTECTIVE NOTICES:

The copyright in this document and the associated drawings are the property of IS-Instruments Ltd. and all rights are reserved. This document and the associated drawings are issued on condition that they are not copied, reprinted or reproduced, nor their contents disclosed. The publication of information in this documentation does not imply freedom from any patent or proprietary right of IS-Instruments or any third party.

TRADEMARKS & PATENT INFORMATION

IS-Instruments and the ISI logo are trademarks of IS-instruments Ltd. All other marks are property of their owners.

Technical Specifications

This document shows the technical specifications of the Cuvette Holder (CUV) accessory for our spectrometers. Further information can be found on the IS-Instruments [website](#). The cuvette holder comes with two collimators as standard, with the option of adding up to two more. A lid is also included.

Specification	Value
Cuvette Holder	
Ports	4 (0.535"–40 tapped)
Cuvette size	Standard micro and macro cuvettes
Optical axis height	8.5 mm from bottom of cuvette
Mounting options	Each face has 4 x UNC4-40 tapped holes compatible with cage systems from leading manufacturers. Bottom face has M4 post mounting hole
Material	3D printed nylon
Finish	Matt Black
Dimensions (mm)	40 x 40 x 40 (43 x 43 59.5 with lid)
Weight	Approx 500 g
Collimators	
Focal length	12mm
Optical Fibre coupling	SMA as standard (FC/PC on request)
Wavelength	350 – 700nm (uncoated or 650-1050nm on request)
Dimensions (mm)	Ø16 x 25 (approx.)

Mechanical Drawings

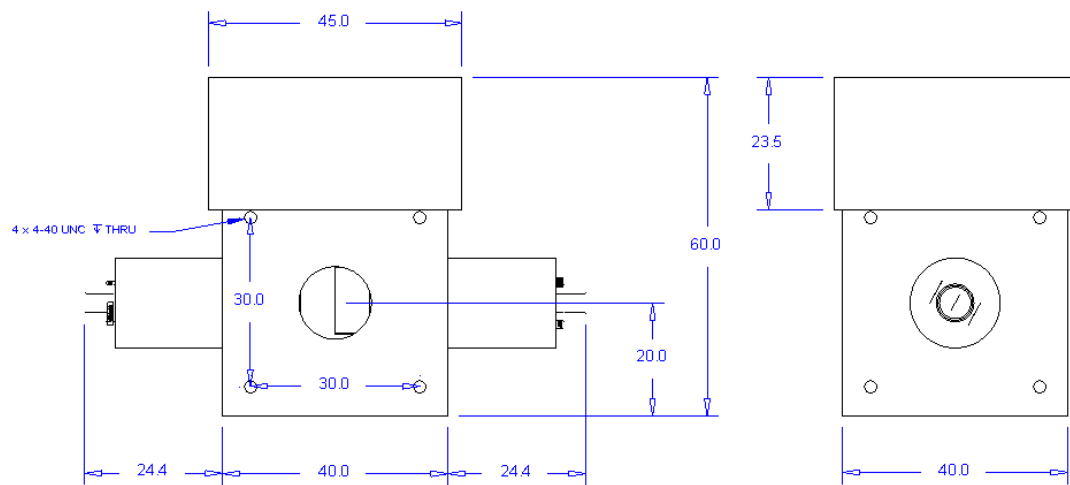

Figure 1 CUV Mechanical drawing. All dimensions are given in millimetres.

All ports are tapping through to the central opening for the cuvette. A brass M4 thread insert is provided in the bottom of the unit for convenient mounting.